



Finnhoist

rst-nostolaitteet.fi

Made in Italy

[www.armanni.com](http://www.armanni.com)



LIFT  
TABLES





# Italian Manufacturers Since 1976

For over 40 years our design team examines the handling problem with you, collects all necessary details and, thanks to an in-depth know-how that was reached following the manufacture of more than 70,000 machines, we can always offer the most suitable solution for your business activity

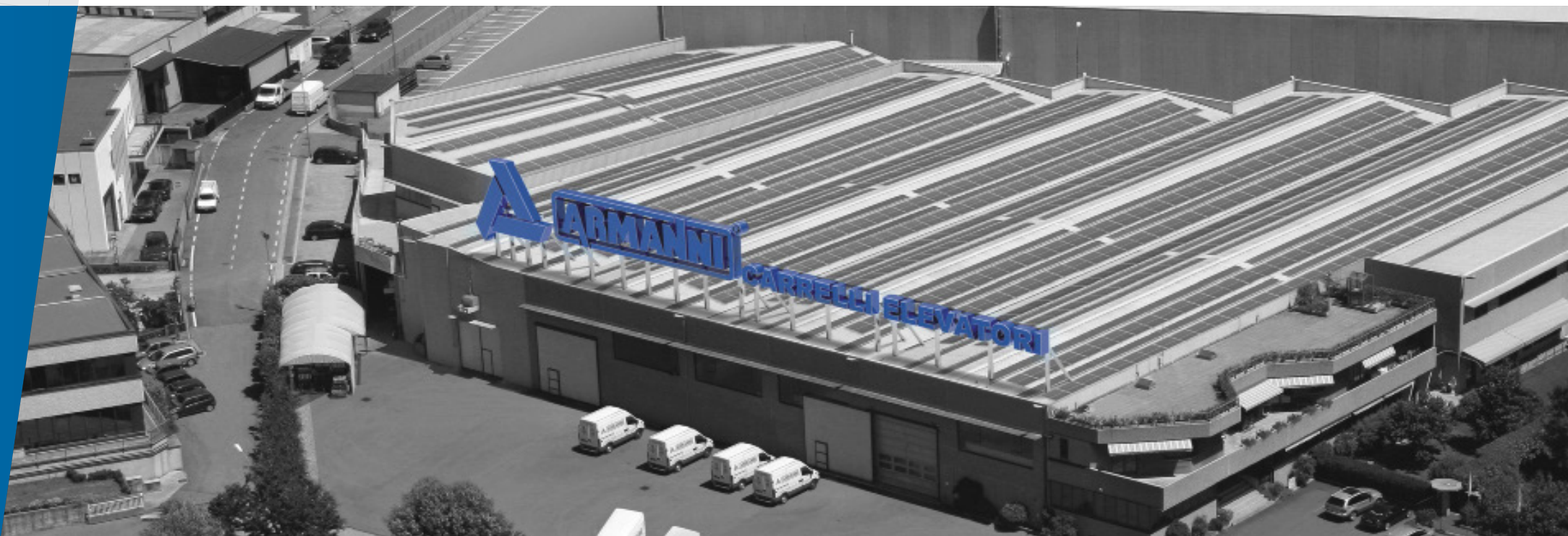

# Table of contents



## Introduction

The Company	4
How to choose a lift table	7

## Pantograph lift tables

Manual lift tables	10
Electric lift tables	12
Accessories	16

## Workbench lift tables

Manual and electric lift tables	20
---------------------------------	----

## Tilting lift tables

Up-enders	26
-----------	----

## Moveable lift tables

Moveable lift tables	30
Accessories	33

## XXL lift tables

XXL lift tables	36
-----------------	----

## The Armanni® world

Social Network	40
----------------	----



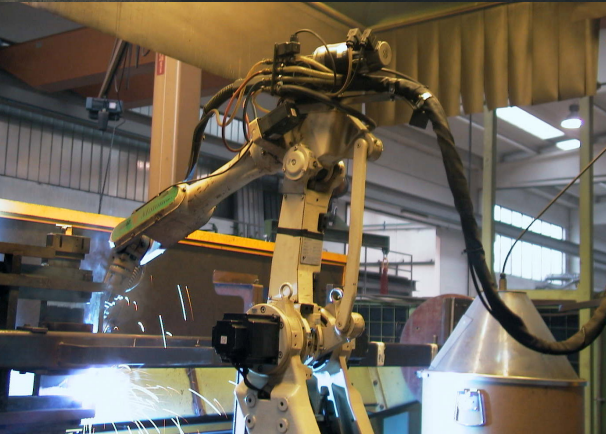

## The company

Within the **15,000 sqm** of the modern headquarters located in Albino (BG), Italy, in the industrial heart of the Lombardy region, Armanni Carrelli Elevatori **manufactures** a broad range of lift trucks and pallet trucks, which are capable of handling all goods, thus **meeting the needs** of craft businesses up to big companies.

In more than **40 years** of business activity, Armanni Carrelli Elevatori has been able to become a reference leader within the industry of lift trucks, which are especially suitable in cases that are characterised by reduced spaces and in logistic situations that require the utmost versatility. Armanni's wide range of products comprehensively covers both capacities and lifting heights; furthermore, it includes manual to completely electronic lift trucks, single- or double-pantograph lifting tables up to special customised products to handle reels, empty drums, tilt bins or handle loads which are particularly heavy and bulky.

The Armanni team's competitiveness is based on factors that are on the same wavelength of the most up-to-date dynamics of modern industry: design with a "problem solving" mindset starting from the specific needs of the customer, always assure high and constant quality levels, supplement the structural resistance of its trucks with all advantages of a "friendly technology," such as ergonomics, optimisation of the space, as well as easy management and maintenance..

## Mission

**"Your needs at the core of our business!"**

The long-lasting business activity within the industry of goods handling made our mission clearer and clearer: Your needs are at the core of everything we do!

For us, successfully meet your needs means completely changing the point of view about goods handling problems: you do not need to adapt your work to the lift truck any more, as we will design the best solution for your business together with you.

More than **40 years** of **experience**, more than **70,000 manufactured machines** and more than **1,000 customers** in more than **40 different countries** allow us to state that if you see handling problems and difficulties during the performance of your activity, we can find solutions that can make your work safer, more efficient and effective.

## Our History

The history of Armanni Carrelli Elevatori is characterised by small, but sound growth steps, which allowed it to become a **quality brand** that is renowned and appreciated all over the world.

Founded in 1976 thanks to the resourcefulness of the three Armanni brothers, it underwent a **progressive transformation process** in time, thus changing from a small craft enterprise to a **reliable industrial business**.

Its history dates back more than 40 years, which is a tangible and clear sign of its ability to successfully combine **in-depth technical knowledge** with a **strong entrepreneurial spirit**, allowing the company to provide the market with products that are always **innovative** and winning.



# Global presence



## Headquarters

The headquarters and sole production site of Armani® is located in Albino (Bg). For this reason the production is 100% "Made in Italy"



## Distributors

The Armani® distributor network covers a global presence with over 1000 regular customers in over 45 countries.



## Strategic partners

Our strategic partners are exclusive Armani® distributors for their target market which means points of reference for their Country

# The lift table

To be used within manufacturing departments, warehouses or automated plants, the varied range of ARMANNI's lift tables are crucial machines that make important operations effective and fully compliant with the law, such as lifting of goods, loading and unloading of goods into/from lorries, maintenance or connect work surfaces that are arranged at different heights. The size of the traditional single- or double-pantograph platforms can be customised according to the requirements of the customer and they can be equipped with several optional accessories; Armanni's offered solutions then cover products that were specifically designed for particular uses, such as lift tables that can be used as work benches, lift

## Main uses

- Connection between different working levels
- Loading/unloading goods from lorries
- Plants and machinaries integration
- Ergonomic workstation
- Goods tilting from vertical to horizontal position
- Loads handling and positioning

## Application fields

- Paper industry
- Packaging industry
- Textile industry
- Pressing and moulding industry
- Chemical and pharmaceutical industry
- Building industry
- Aviation, Nautical, Automotive industry
- Railway industry
- Industrial integration plants
- Metalworking industry
- Food & Beverage industry
- Oil & Gas industry

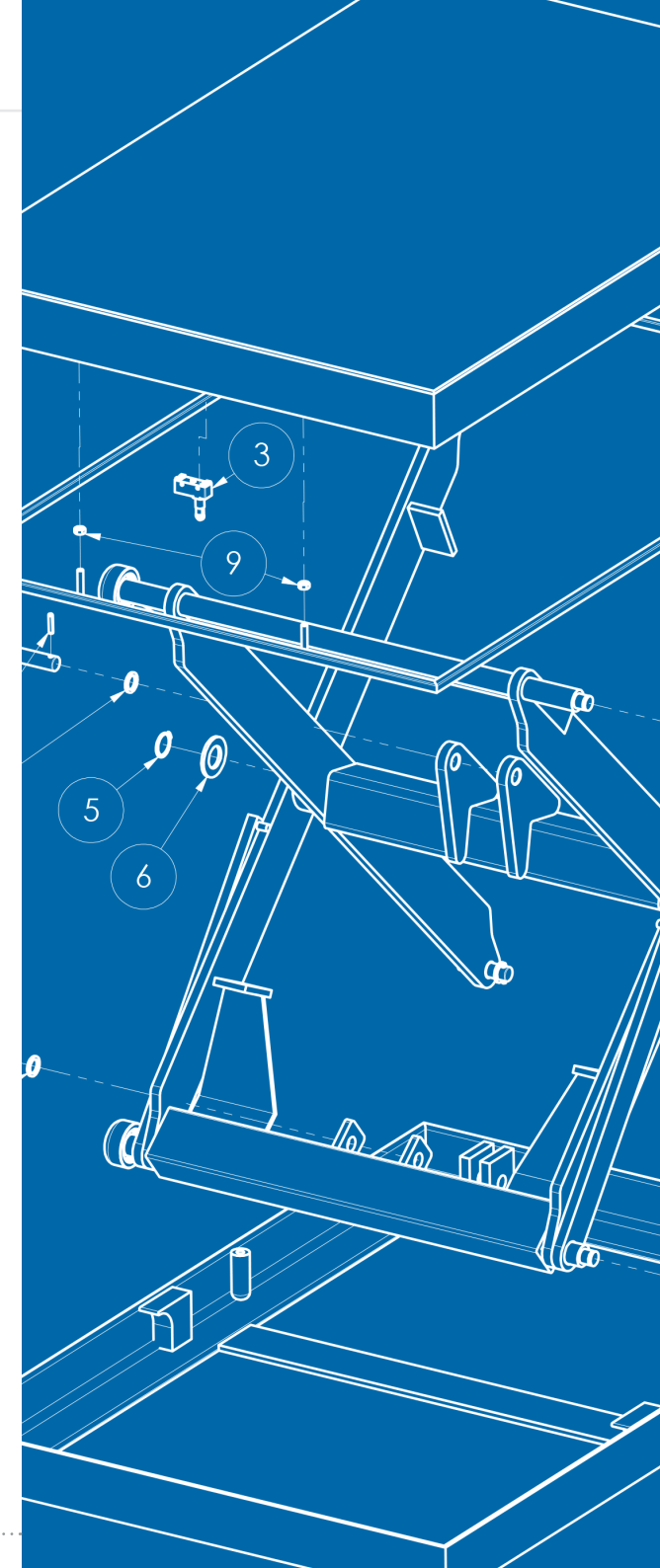

# How to choose a lift table

To correctly choose a lift table, it is necessary to know exactly the work that the table will perform. For this reason it is essential to collect a series of data for identifying the correct model. Our goal is to provide a high quality product that fully satisfies the customer's handling needs. For this reason, the Armanni® team provides its know-how acquired in over 40 years of activity, involving the customer in a phase of co-creation of the machine.

## Technical data of the lift table

- Capacity (Kg)
- Platform dimension (A x B)
- Lift stroke (S)
- Collapsed height (H1)
- Maximal height (H2)
- Type of operation (hand-held pendant control, push-button panel, remote control, PLC connection)
- Type of lifting (manual or electro-hydraulic)
- Lifting engine location
- Number of daily liftings
- Number of daily shifts and estimated life
- Lifting accuracy and precision
- Typology (fixed or moveable)

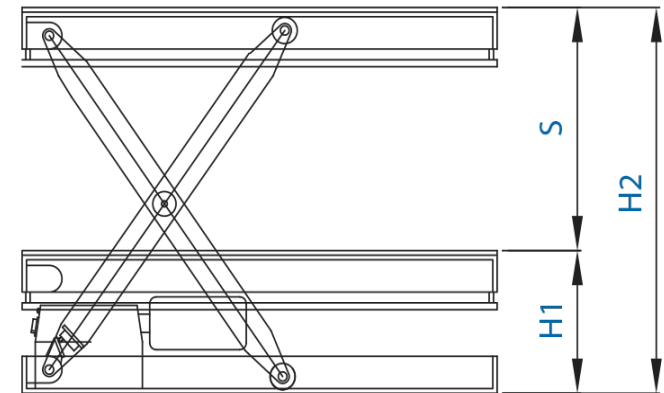

## Load features

- Load typology
- Weight
- Dimension and characteristics
- Weight distribution and center of gravity

## Lift table installation

- Indoor
- Outdoor
- Pit installation
- Plant integration

## Working area features

- Working area description
- Main risks
- Climatic and hygrometric conditions
- Potential use of chemical substances

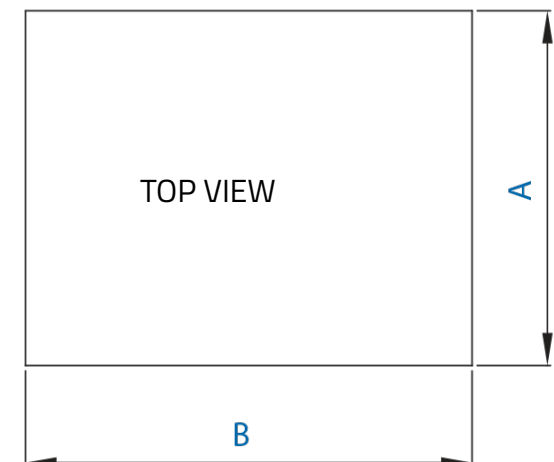



# Pantograph lif tables

*manual o electro-hydraulic*



Complete range of lift tables with manual or electro-hydraulic lifting by pantograph mechanism. By pushing the handle, the manual version allows manual movement of the lift table in order to better serve different work positions. This version allows lifting operations by a double-acting manual pump. In the electro-hydraulic version the drive is replaced by a held-hand pendant control, also available in a wireless version, or can be managed directly by PLC. The Armanni® proposal offers the possibility to choose between various standard configurations (capacity, platform size and lifting stroke) or, if necessary, to request the customization of the dimensional characteristics based on the specific needs of any work environment.



## TM manual lift table



TM is a wheeled lift table with pantograph lifting that is manually driven by means of a lifting pump; the driving handle allows the manual movement of the lift table that, therefore, can serve work stations that are located in different positions. Armanni's offered products allow selecting among several standard set-ups (capacity, size of the platform and lifting stroke) or, if necessary, to ask for the customisation of the size according to the specific needs of the work premises being concerned.

### Lifting and traction

TM can be a valid ally in the different manufacturing phases given that it combines the liftable table characteristics with the possibility of being moved easily just by pushing it from the corresponding handle, ensuring safe and accurate displacements.

### Maximum customization

Numerous customization possibilities, from platform dimensions to lifting capacity and equipment with specific accessories:

- Platform with rollers to improve goods sliding
- load containing guardrails to improve safety during movements

- Linking or turning platforms to improve ergonomics during machine serving operations
- Stable frame with swivel wheels to improve efficiency, productivity and safety conditions

### Lifting range

From 500Kg to 1000Kg

### Quality and affordability

TM is the entry-level model of Armanni® and it combines manual lifting with manual traction. Thanks to the "Made in Italy" identity of this product, it guarantees high quality standards combined with an affordable and convenient price.



### Double-acting manual pump

A double pump makes lifting fast and easy. Lowering by gravity is controlled by a proportional hand operated valve in the pump body.

### Sliding on high quality bearings

Maintenance free high quality bearings support the scissor mechanism to ensure smooth movement during lifting and lowering.

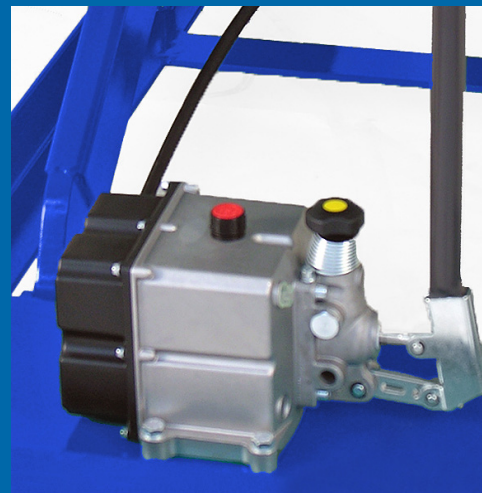

### Standard equipment

- Pins mounted on sintered bushings
- Chromed oleo-dynamic piston
- Lifting with double-acting manual pump
- Lowering by proportional hand operated valve
- Polyamide core wheels with polyurethane cover
- Swivel back wheels
- Foot parking brake
- Manual translation
- Accided prevention systems



## TM 5

Configurable with platforms of different sizes, in the standard configuration, TM 5 allows you to manually move loads up to 500 kg with the possibility of lifting up to 1300 mm.

Model	A	B	H1	H2	S	Capacity (Kg)
TM 5.01	600	1200	335	1000	665	500
TM 5.02	800	1600	335	1300	965	500

## TM 10

Configurable with platforms of different sizes, in the standard configuration, TM 5 allows you to manually move loads up to 1000 kg with the possibility of lifting up to 1300 mm.

Model	A	B	H1	H2	S	Capacity (Kg)
TM 5.01	600	1200	335	1000	665	500
TM 5.02	800	1600	335	1300	965	500

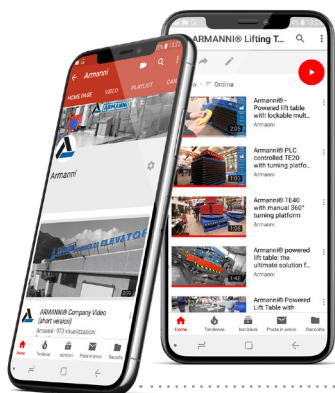

Scan the QR code to watch the video

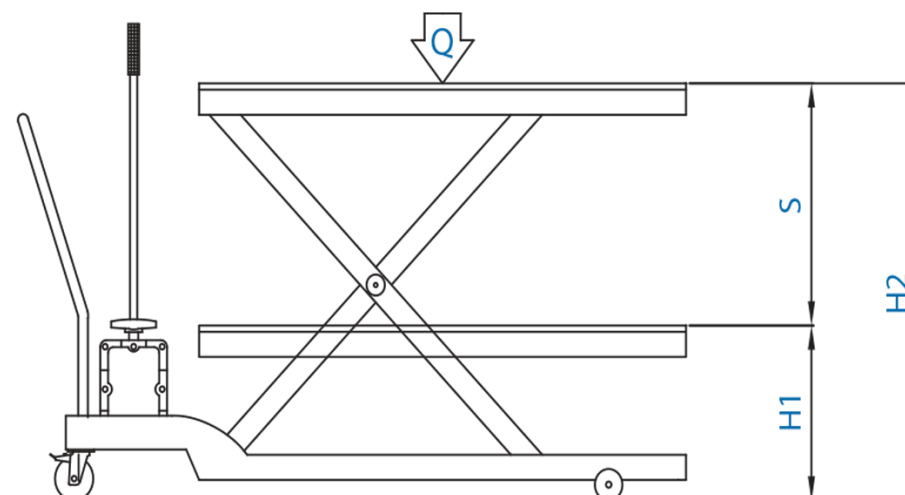
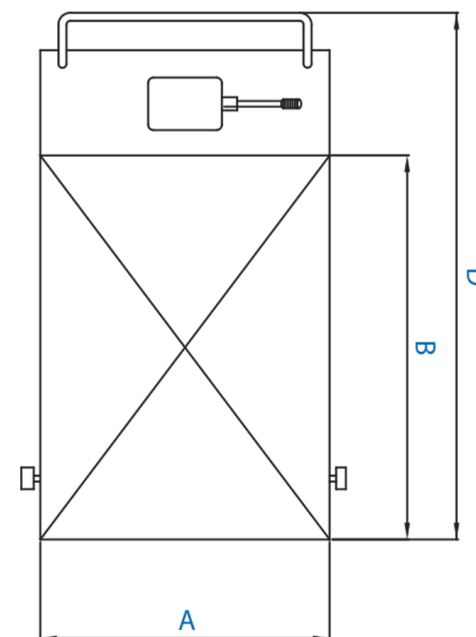



## TE electro-hydraulic table

TE is an electro-hydraulic pantograph lift table; Armanni's offered products allow selecting among several standard set-ups (capacity, size of the platform and lifting stroke) or, if necessary, to ask for the customisation of the size according to the specific needs of the work premises being concerned. Possibility to set up the lifting platforms with vertical double-pantograph lifting system to reach maximum heights with minimum overall dimensions. A wide range of optional accessories is available.

### Motor-driven lifting

Thanks to the motor-driven lifting through electro-hydraulic control unit fed by the mains available for the table, it is possible, even in the standard configuration, to easily and safely lift loads of up to 5000 Kg.

### Maximum customization

Large number of customization possibilities, from the table measurements to the lifting capacity, up to the installation of specific accessories

### Possibility of motorising traction

In addition to the possibility of motorising lifting through electro-hydraulic control units, fed either by the mains or by through batteries, it is also possible to motorise electric

traction, for long displacements or in order to facilitate movements in case of large or heavy platforms.

### Lifting range

From 500 Kg to 5000 Kg

### Large dimensions, great heights

TE represents the top model of the Armanni® line with many possibilities for customization in terms of dimensions and lifting.

Possibility of designing and manufacturing tables with platforms of large dimensions passable by lift trucks or cars with reinforced structures in order to ensure maximum capacities and with double pantograph structures for more elevated lifting operations



### Safety perimeter

Sensors at the bottom of the platform detect obstacles in the operating area and immediately stop the lowering operation.

### Strength and reliability

Rigid welded steel frames, self lubricating pivot bearings and chrome plated hydraulic cylinder rods offer long life and trouble free operation.



### Standard equipment

- Hydraulic power plant 380/220V
- Three-phases lifting engine
- Pins mounted on sintered bushings
- Chromed oleo-dynamic piston
- Lifting and lowering push-buttons
- Slide on bearings
- Strong electro welded steel frame
- Safety perimeter
- Accident prevention systems

## TE 5

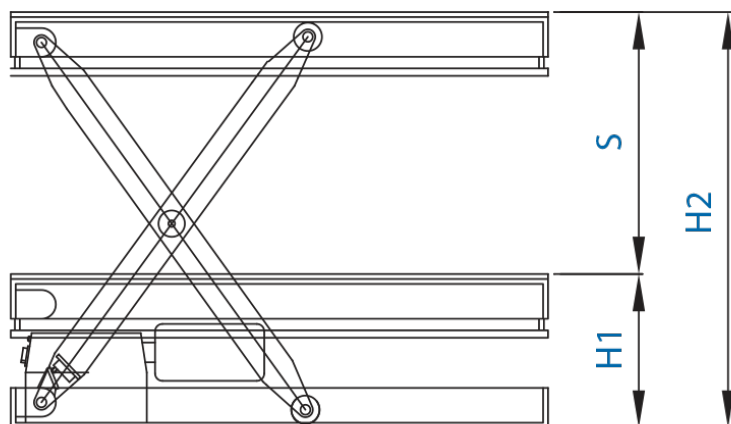

Model	A	B	H1	H2	S	Capacity (Kg)
TE 5.01	600	1200	250	950	700	500
TE 5.02	800	1200	250	950	700	500
TE 5.03	800	1600	250	1200	950	500
TE 5.04	1000	1200	250	950	700	500
TE 5.05	1000	2000	350	1500	1150	500
TE 5.06	1250	2500	400	1850	1450	500
TE 5.07	1500	3000	400	2150	1750	500

## TE 10

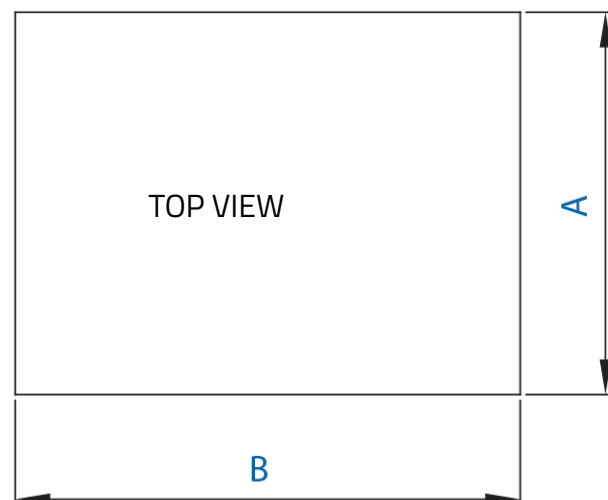

Model	A	B	H1	H2	S	Capacity (Kg)
TE 10.01	600	1200	250	950	700	1000
TE 10.02	800	1200	250	950	700	1000
TE 10.03	800	1600	250	1200	950	1000
TE 10.04	1000	1200	250	950	700	1000
TE 10.05	1000	2000	350	1500	1150	1000
TE 10.06	1250	2500	400	1850	1450	1000
TE 10.07	1500	3000	400	2150	1750	1000



Scan the QR code to watch the video

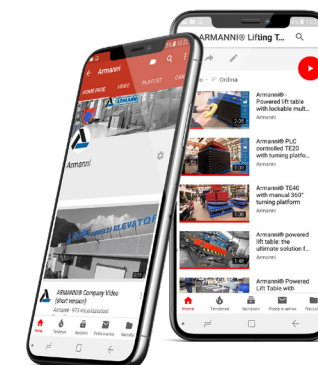



## TE 15

Model	A	B	H1	H2	S	Capacity (Kg)
TE 15 .01	1000	1200	300	1000	700	1500
TE 15 .02	1000	1600	300	1250	950	1500
TE 15 .03	1000	2000	350	1500	1150	1500
TE 15 .04	1200	1800	300	1350	1050	1500
TE 15 .05	1250	2500	400	1850	1450	1500
TE 15 .06	1400	2000	400	1550	1150	1500
TE 15 .07	1500	3000	400	2150	1750	1500
TE 15 .08	2000	3000	400	2150	1750	1500

## TE 20

Model	A	B	H1	H2	S	Capacity (Kg)
TE 20 .01	1000	1200	300	1000	700	2000
TE 20 .02	1000	1600	300	1250	950	2000
TE 20 .03	1000	2000	350	1500	1150	2000
TE 20 .04	1200	1800	350	1400	1050	2000
TE 20 .05	1250	2500	400	1850	1450	2000
TE 20 .06	1400	2000	400	1550	1150	2000
TE 20 .07	1500	3000	400	2150	1750	2000
TE 20 .08	2000	3000	400	2150	1750	2000

## TE 25

Model	A	B	H1	H2	S	Capacity (Kg)
TE 25 .01	1000	1200	300	1000	700	1500
TE 25 .02	1000	1600	300	1250	950	1500
TE 25 .03	1000	2000	350	1500	1150	1500
TE 25 .04	1200	1800	350	1400	1050	1500
TE 25 .05	1250	2500	400	1850	1450	1500
TE 25 .06	1400	2000	400	1550	1150	1500
TE 25 .07	1500	3000	400	2150	1750	1500
TE 25 .08	2000	3000	400	2150	1750	1500

## TE 30

Model	A	B	H1	H2	S	Capacity (Kg)
TE 30 .01	1000	1200	350	1050	700	3000
TE 30 .02	1000	1600	350	1300	950	3000
TE 30 .03	1000	2000	400	1500	1150	3000
TE 30 .04	1200	1800	400	1450	1050	3000
TE 30 .05	1250	2500	450	1900	1450	3000
TE 30 .06	1400	2000	400	1550	1150	3000
TE 30 .07	1500	3000	450	2200	1750	3000
TE 30 .08	2000	3000	450	2200	1750	3000



## TE 40

Model	A	B	H1	H2	S	Capacity (Kg)
TE 40 .01	1000	1200	500	1200	700	4000
TE 40 .02	1000	1600	500	1450	950	4000
TE 40 .03	1000	2000	500	1650	1150	4000
TE 40 .04	1200	1800	500	1550	1050	4000
TE 40 .05	1250	2500	500	1950	1450	4000
TE 40 .06	1400	2000	500	1650	1150	4000
TE 40 .07	1500	3000	500	2250	1750	4000
TE 40 .08	2000	3000	500	2250	1750	4000

## TE 50

Model	A	B	H1	H2	S	Capacity (Kg)
TE 50 .01	1000	1200	550	1250	700	5000
TE 50 .02	1000	1600	550	1500	950	5000
TE 50 .03	1000	2000	550	1700	1150	5000
TE 50 .04	1200	1800	550	1600	1050	5000
TE 50 .05	1250	2500	550	2000	1450	5000
TE 50 .06	1400	2000	550	1700	1150	5000
TE 50 .07	1500	3000	550	2300	1750	5000
TE 50 .08	2000	3000	550	2300	1750	5000



# Accessories



Foldable dock plate

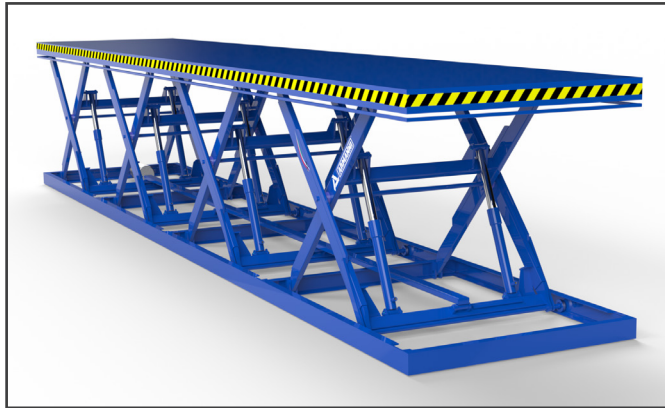

Horizontal multi-pantograph



Vertical double scissor

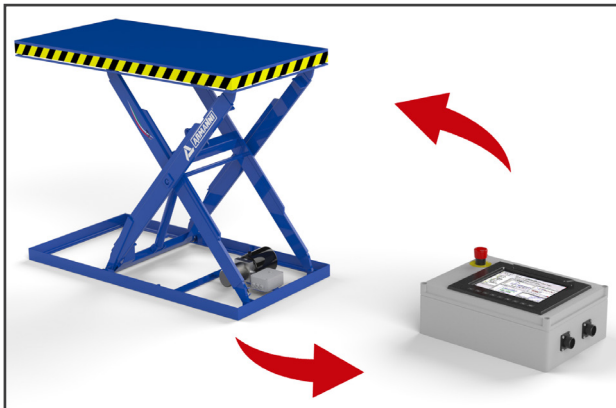

PLC connection arrangement

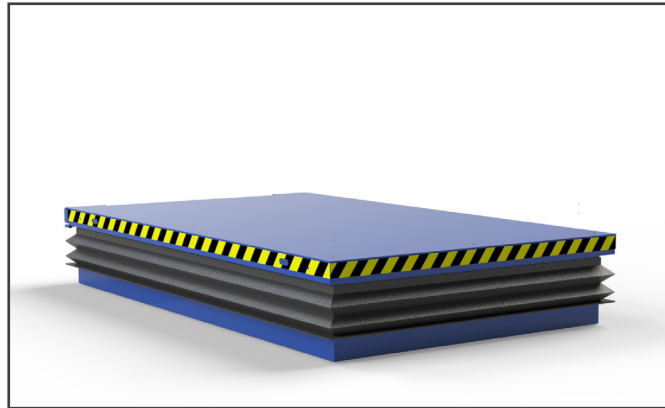

Protective bellows



Wireless remote control





Platform with rollers or spheres



V-shaped platform



Turning platform



Tilting platform



Omnidirectional platform



Fall protection guardrails and gates

Accessories	TM 5	TM 10	TE 5	TE 10	TE 15	TE20	TE 25	TE 30	TE 40	TE 50
Vertical double scissor	✓	✓	✓	✓	✓					
Horizontal multi-pantograph			✓	✓	✓	✓	✓	✓	✓	✓
Fall protection guardrails and gates			✓	✓	✓	✓	✓	✓	✓	✓
Foldable dock plate			✓	✓	✓	✓	✓	✓	✓	✓
Protective bellows	✓	✓	✓	✓	✓	✓	✓	✓	✓	✓
V-shaped platform	✓	✓	✓	✓	✓	✓	✓	✓	✓	✓
Turning platform	✓	✓	✓	✓	✓	✓	✓	✓	✓	✓
Tilting platform			✓	✓	✓	✓	✓	✓	✓	✓
Platform with rollers or spheres	✓	✓	✓	✓	✓	✓	✓	✓	✓	✓
Omnidirectional platform	✓	✓	✓	✓	✓	✓	✓	✓	✓	✓
PLC connection arrangement			✓	✓	✓	✓	✓	✓	✓	✓
Wireless remote control			✓	✓	✓	✓	✓	✓	✓	✓





# Workbench lift tables

*manual or electro-hydraulic*





Wheeled lift tables with vertical piston lifting, which can be electro-hydraulically or manually driven; the driving handle allows the manual movement of the lift table that, therefore, can serve different work stations. According to the Armanni® philosophy, the workbench lift tables can be customized, especially in the platform which can be equipped with a wide range of accessories like roller conveyors, sliding spheres and platform sideshift in order to respond to the most varied requirements in different working premises.





## GAMMA 800 M manual lift table

GAMMA 800 M is the manual lift table in which lifting is obtained by means of a double-acting manual pump; with a capacity of 800 Kg and lifting of up to 1475 mm, it is the ideal equipment for the service to machine tools and operators

### Manual lifting and traction

Thanks to the traction solution (through push handle) and manual lifting, it represents the ideal solution for the service to machines in any part of the company, even in areas without power supply.

### Reduced dimensions

Thanks to the lifting system with piston in vertical position, without pantograph structure, it is possible to contain the dimensions; GAMMA 800 M thus becomes the ideal tool as work table for the operator or service to the machine tools.

### Quality and affordability

GAMMA 800 M is the entry-level model of Armanni® and it combines manual lifting with manual traction. Thanks to

the "Made in Italy" identity of this product, it guarantees high quality standards combined with an affordable and convenient price.

### Suitable for any industries

There are numerous accessories that can be installed on the GAMMA 800 M platform. Thanks to the many possibilities of customization, the table is particularly suitable to any working field.

### Lifting capacity

800 Kg



### Driving handle and swivel wheels

Driving handle improves ergonomics during lift table movement operations; back swivel wheels with parking foot brake improve handling and safety.

### Double-acting manual pump

The double-acting manual pump makes lifting fast and easy. Lowering by gravity is controlled by a hand operated valve in the pump body.

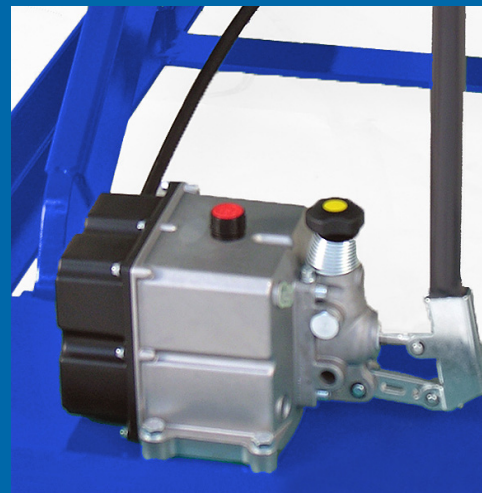

### Standard equipment

- Pins mounted on sintered bushings
- Chromed oleo-dynamic piston
- Lifting with double-acting manual pump
- Lowering by proportional hand operated valve
- Polyamide core wheels with polyurethane cover
- Swivel back wheels
- Foot parking brake
- Manual translation
- Accided prevention systems



## GAMMA 800 12V electro-hydraulic lift table

GAMMA 800 12V is the electric lift table in which lifting is obtained by means of an electro/hydraulic control unit fed by a 12 V battery; with a capacity of 800 Kg and lifting up to 1475 mm, it is the ideal equipment to serve workshop's machines and operators.

### Motor-driven lifting and manual traction

Motor-driven lifting through electro-hydraulic control unit fed by battery; thanks to the built-in battery charger, it is also possible to recharge it directly where it is being used. Finally, with the comfortable push handle, it is possible to manually move the load in a safe and accurate way.

### Quality and affordability

GAMMA800 12V represents the top model of the Armanni® workbench lift tables line. Thanks to the combination of manual traction and electro-hydraulic lifting, the table is extremely versatile and easy to use. Thanks to the "Made in Italy" identity of this product, it guarantees high quality standards combined with an affordable and convenient price.

### Reduced dimensions

Thanks to the lifting system with piston in vertical position, without pantograph structure, it is possible to contain the dimensions; GAMMA 800 12V thus becomes the ideal tool as work table for the operator or service to the machine tools.

### Suitable for any industries

There are numerous accessories that can be installed on the GAMMA 800 12V platform. Thanks to the many possibilities of customization, the table is particularly suitable to any working field.

### Lifting capacity

800 Kg



### Driving handle and swivel wheels

Driving handle improves ergonomics during lift table movement operations; back swivel wheels with parking foot brake improve handling and safety.

### Lifting and lowering push buttons

Platform lifting and lowering by means of specific push buttons; emergency stop button for the maximum safety.



### Standard equipment

- Pins mounted on sintered bushings
- Chromed oleo-dynamic piston
- Built-in battery charger and 12V 100Ah battery
- Lifting and lowering by push buttons
- Polyamide core wheels with polyurethane cover
- Swivel back wheels
- Foot parking brake
- Manual translation
- Accided prevention systems
- Emergency stop button

## Technical data

Modello	GAMMA 800 M	GAMMA 800 12V
Q	800 Kg	800 Kg
C	400 mm	400 mm
I	800 mm	800 mm
L	980 mm	980 mm
X	90 mm	90 mm
X2	190 mm	190 mm
Y	700 mm	700 mm
L2	620 mm	620 mm
M-B	750 mm	750 mm
h1	700 mm	700 mm
h2	1475 mm	1475 mm
WA	925 mm	925 mm

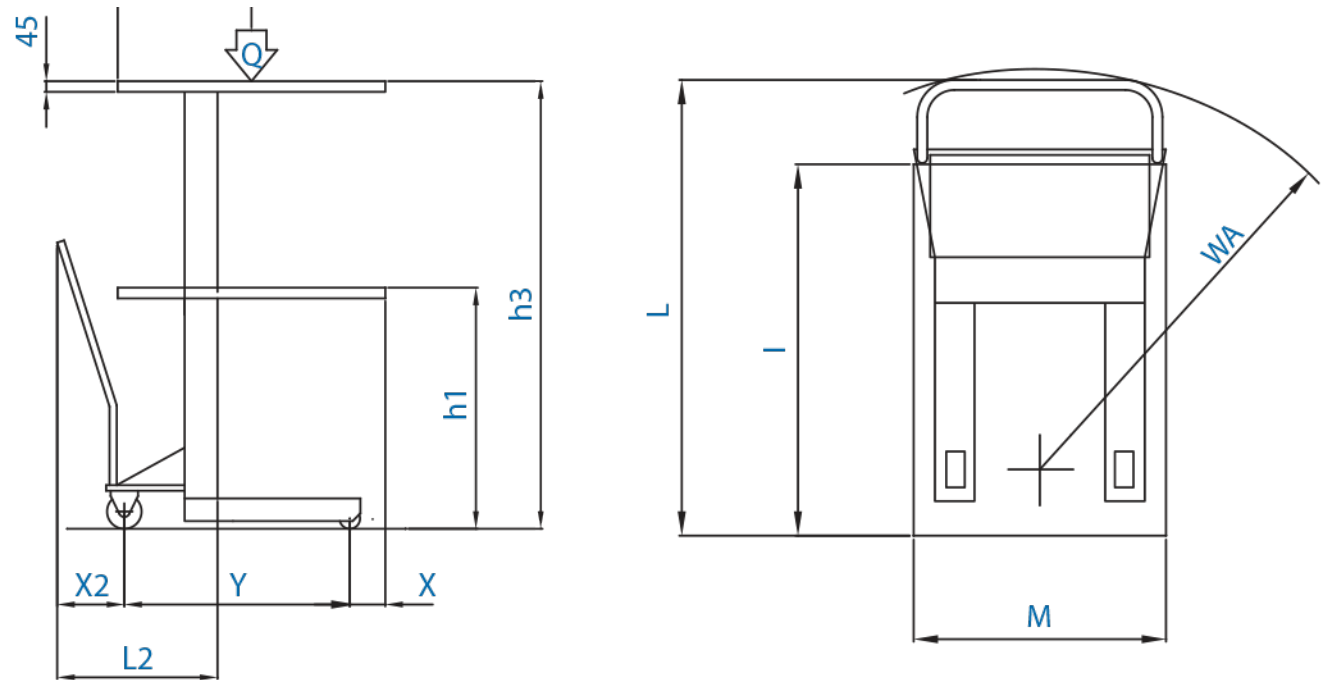

## Accessories



Turning platform



Platform with rollers



Omnidirectional platform



V-shaped platform





# Tilting lift tables

## *Up-enders*



Systems equipped with L-shaped platform to be electro-hydraulically tilted until the load has been completely capsized. The size and the shape of the tilting platforms can be customised to perfectly adapt to the type and the shape of the goods to be handled. They are usually used for various handling operations, such as: tilting of the load from the vertical to the horizontal position and vice versa (plastic, paper reels, etc.), tilting of the lift table to facilitate and make goods loading and unloading operations more ergonomic when using cases or containers or, additionally, operations to change pallets of goods (movement from a wooden to a plastic pallet, etc...)

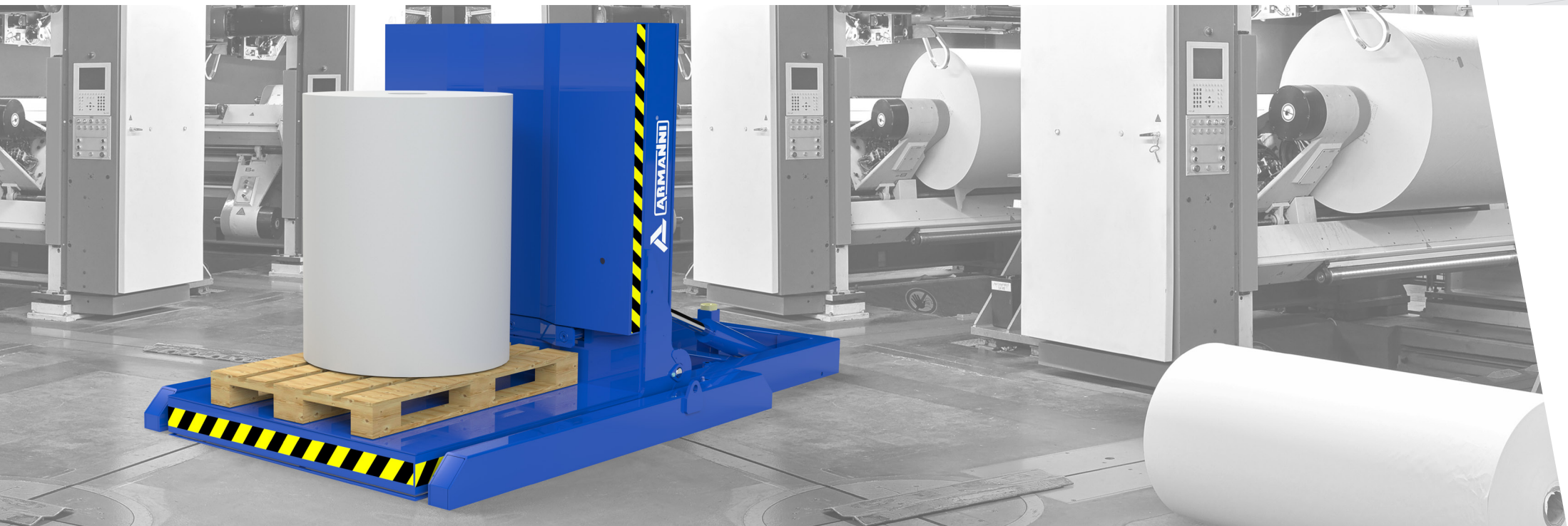



# TR

## tilting lift table

TR is the Armanni® tilting table used for tilting and overturning the load. The range does not include a standard version, which is why TR is fully customizable in capacity and size.

### Tilting and overturning

TR is a handling system with an L-shaped platform (90° angle) used for the electro-hydraulic inclination of the platform until the load is completely overturned.

### Fully customizable

Being that TR doesn't have a standard reference version, it has endless possibilities for customizing the dimensions and shape of the overturning platforms to perfectly adapt to the type and shape of the goods to be handled.



### Application fields

TR is usually used for various handling operations including:

- load overturning from the vertical to the horizontal position and vice versa (paper rolls, plastic rolls, etc.)
- platform tilting to facilitate and improve ergonomics for the operators during goods loading and unloading inside crates or containers
- pallet change operations ( transfer from wooden pallets to plastic pallets, etc.)
- table integration within a plant for connecting different working steps



### Lifting capacity

Being a 100% customizable product, the lifting capacity is at the customer's request.

Scan the QR code to watch the video



Scan me

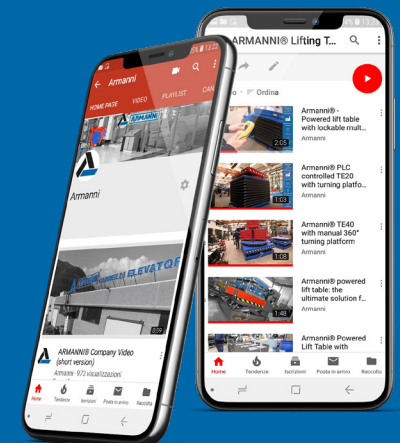





# Moveable lift tables

*Traction and lifting*



Lift tables with pantograph-mechanism lifting, equipped with wheels and electric drive system, as well as driving tiller. The motor-driven movement allows using the lift table and handling the load in different work stations, even if they are in different areas. Possibility to customise the size and the set-up features of the lift table with vertical double-pantograph lifting system to reach maximum heights with minimum overall dimensions. Wide range of accessories are available, such as platform with rollers, tilting or rotating loading platforms and many more to set up the lift table for specific intended uses.





# Moveable lift tables

## traction and lifting

The movable lift tables are tools suitable for intra-facility loads handling with lifting by pantograph mechanism and electric traction system with wheels and driving tiller.

### Traction and lifting

The powered traction allows the movement and use of the lift table with relative transport of the load in different workstations. Used as an ergonomic and mobile workstation it is useful for moving a load between different productive steps or for positioning components at strategic points during the production phases (axles, air filters, engine components, etc.)

### Fully customizable

Not having a standard reference version, Armanni® movable tables have endless possibilities for customization to adapt perfectly to the type and characteristics of the loads to be handled. In combination with a wide range of options, they are able to meet the customer's needs in many industrial sectors



### Application fields

TR is usually used for various handling operations including:

- load positioning and lifting (axles, air filters, components, etc.) underneath means of transportation (trains, buses, cars, trucks, etc.) during manufacturing steps or maintenance
- traction and lifting of the load in an ergonomic position for the operator during the production and assembly steps
- industrial machines supply by transporting and lifting components (pipes, bars, etc.) from the storage areas to the machinery
- productive plant integration to connect different working steps



### Lifting capacity

Being a 100% customizable product, the lifting capacity is at the customer's request.

Scan the QR code to watch the video



Scan me

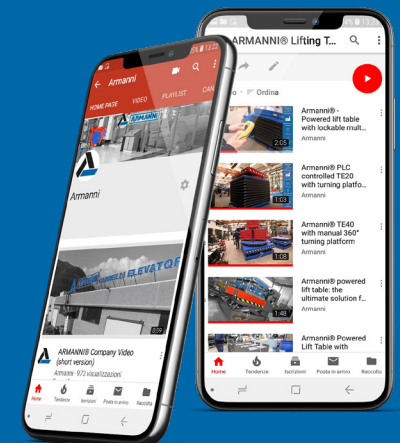



# Accessories



Protective bellows



Wireless remote control



Platform with rollers or sliding spheres



Moveable version for rails

# Accessories



Tilting platform with sideshift



V-shaped platform for roll handling



Turning platform with stops



Omnidirectional platform with stops





# WORLD CLASS MANUFACTURING

ADDETTO ASSEMBLY SHOP

VISITATORE



- 1. I provide clear and concise instructions to the worker.
- 2. I ensure the worker is trained and qualified for the task.
- 3. I provide the worker with the necessary resources and tools.
- 4. I monitor the worker's performance and provide feedback.
- 5. I ensure the worker is safe and healthy.

SAFETY	COST DEPLOYMENT	FOCUS IMPROVEMENT	ATTORNIOS MANUTENANCE	WORKPLACE ORGANIZATION	PERFORMANCE MANAGEMENT	QUALITY CONTROL	INVENTORY & MATERIALS	WASTE MANAGEMENT	ENVIRONMENTAL PROTECTION	SAFETY
SAFETY	COST DEPLOYMENT	FOCUS IMPROVEMENT	ATTORNIOS MANUTENANCE	WORKPLACE ORGANIZATION	PERFORMANCE MANAGEMENT	QUALITY CONTROL	INVENTORY & MATERIALS	WASTE MANAGEMENT	ENVIRONMENTAL PROTECTION	SAFETY

ASSEMBLY SHOP



ARMANI



# XXL lift tables

*Extra-large sizes and capacities*





Lift tables whose bearing framework and size of mechanical components are specifically designed to assure fully efficient and safe conditions even when lifting goods that are considered exceptional due to their weight and overall dimensions. Steel extra-resistant sections combined with the use of horizontal multi-pantograph solutions does not put limitations to the size of these heavy duty lift tables.



# XXL lift tables

## extra-large sizes and capacities

XXL lift tables designed to meet the need of handling extra-large loads both in terms of dimensions and weight.

### Extra-heavy frame

The Armanni® XXL lift tables are specifically designed, both in the load-bearing structure and in the dimensioning of the mechanical components, to guarantee full efficiency and safety during lifting of goods which, in terms of weight and bulk, are configured as exceptional loads. Thanks to a meticulous design study, the tables are made maintaining high quality standards that result in extra-sturdy frame structures.

### Fully customizable

Not having a standard reference version, Armanni® XXL tables have endless possibilities for customization to adapt perfectly to the type and characteristics of the loads to be handled. In combination with a wide range of options, they are able to meet the customer's needs in many industrial sectors

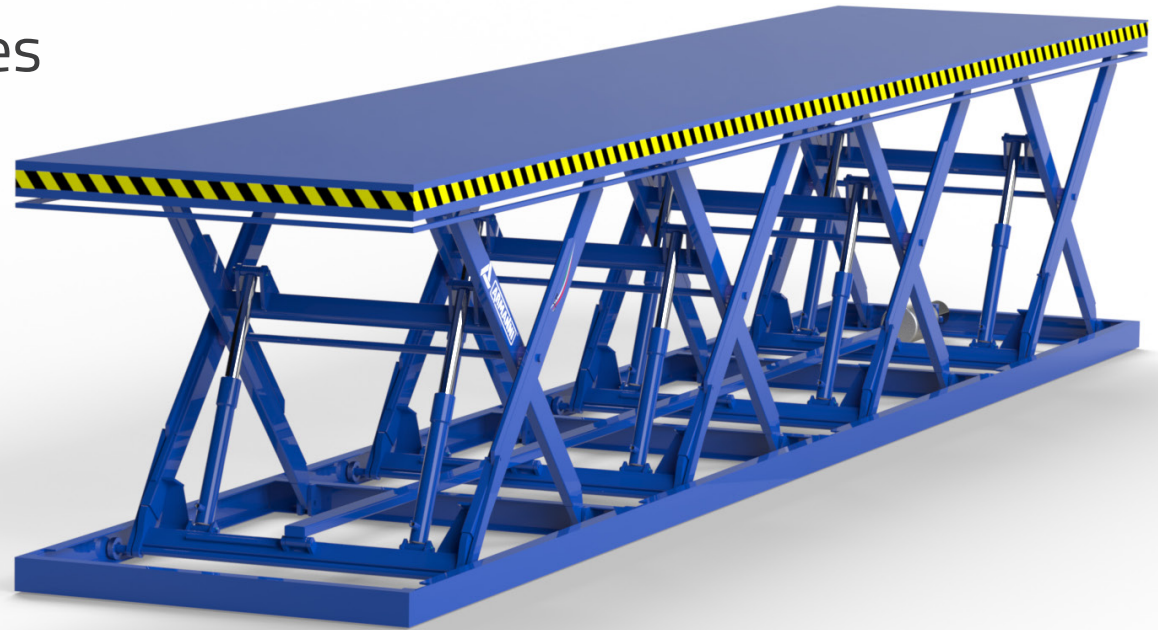

### Application fields

TR is usually used for various handling operations including:

- connection between different levels
- integration in large-scale production facilities (glass plates, paper rolls, molds, metal semi-finished products, mechanical components, etc.) for the connection between different working steps
- integration in automated production lines (automobile assembly and assembly lines, railway industries, mechanical industries, etc.) for the connection between different levels
- lifting and lowering of XXL loads to ensure a safe and ergonomic workstation during assembly and assembly



### Lifting capacity

Being a 100% customizable product, the lifting capacity is at the customer's request.

Scan the QR code to watch the video



Scan me

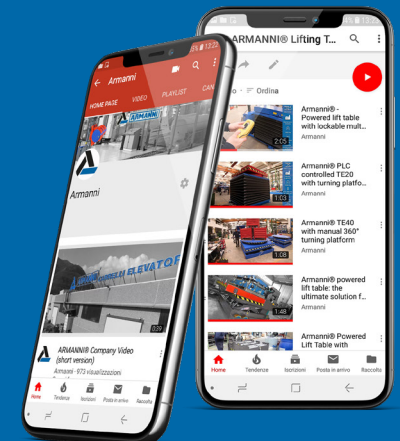







**Stay updated**

# MEDIA**CONTENTS**

Stay updated by consulting our brand new website or by subscribing our newsletter program. Social media will keep you informed on our latest custom products.



# New website!

## www.armanni.com

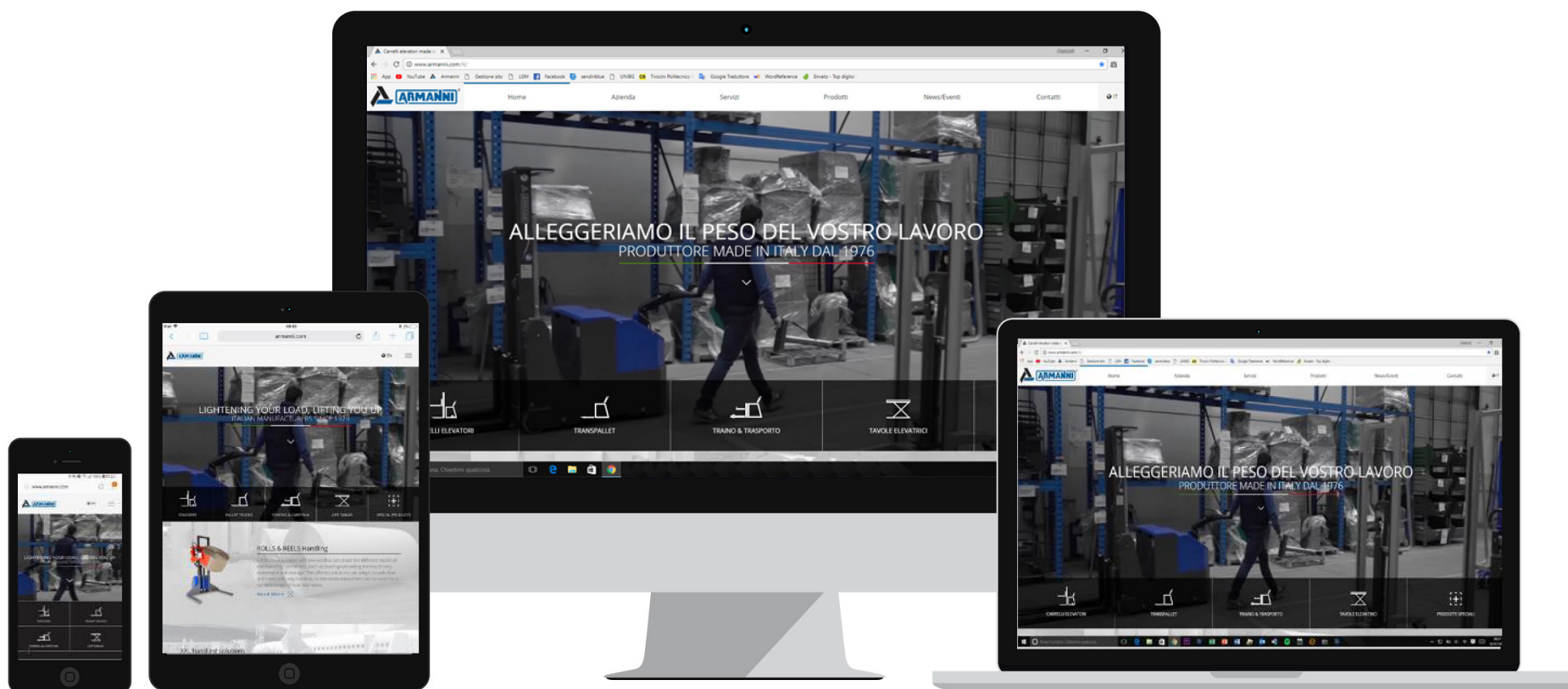

### Responsive design

Adaptable to different devices



### Website

[www.armanni.com](http://www.armanni.com)



### HD graphic contents

Full HD photos and videos.

# Subscribe the NEWSLETTER

## Enter to the Armanni® world

By subscribing our newsletter program you will be updated on our latest news. It's a great strategy to keep in touch with the company and help you to improve your sales. The newsletters are designed with a responsive design that can be read via smartphone, tablet or PC.



### Stay updated

Discover our latest news by signing up the newsletter program



### Subscribe the program

Check out the newsletter with any device; the design is responsive!

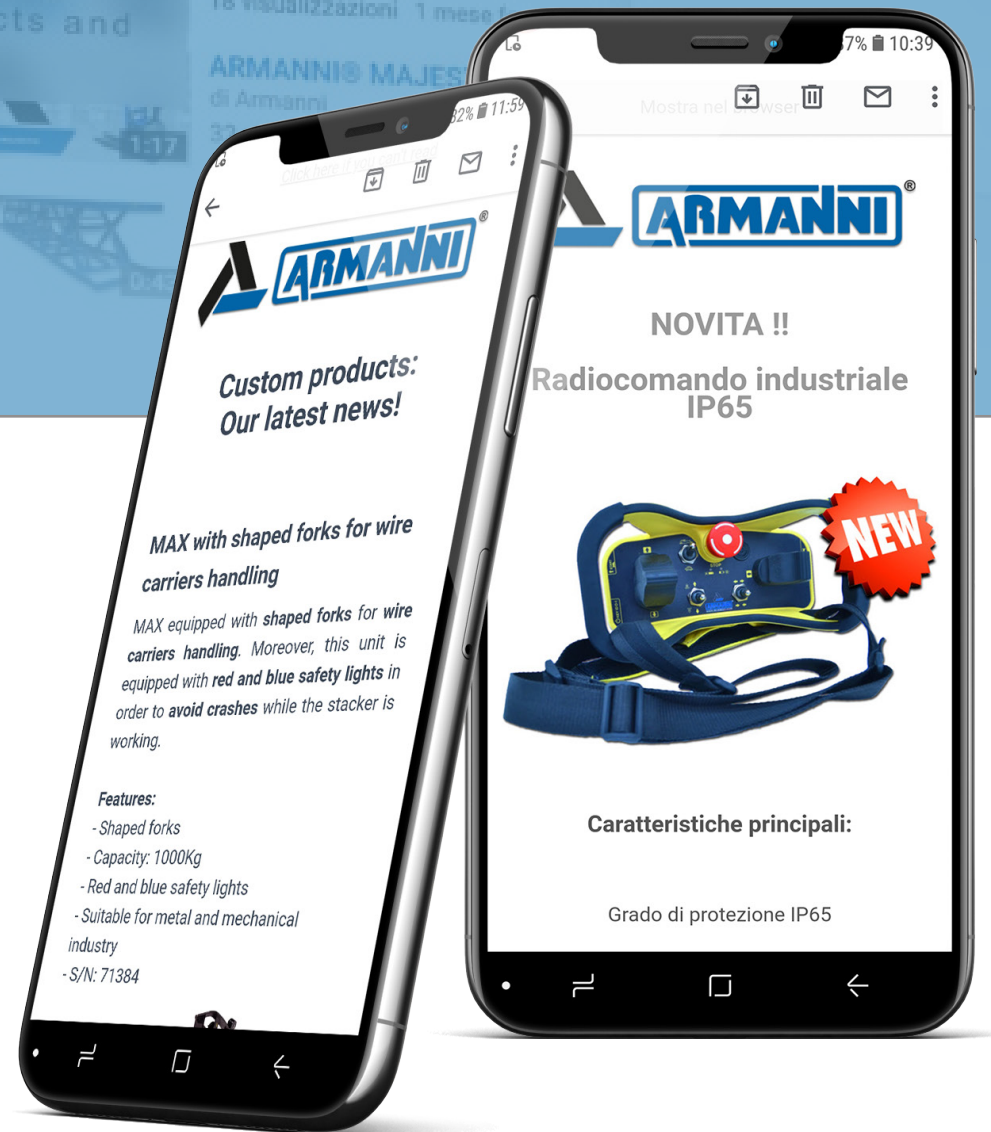

# Subscribe our YouTube Channel

## Stay tuned

- Subscribe our YouTube channel and activate notifications; you will receive a notification directly on your device for each video uploaded
- Stay updated on our latest news
- Share the videos directly to your customers using your smartphone or tablet device



@armanni



@armanni.carrelli elevatori



@armanni\_lifttrucks

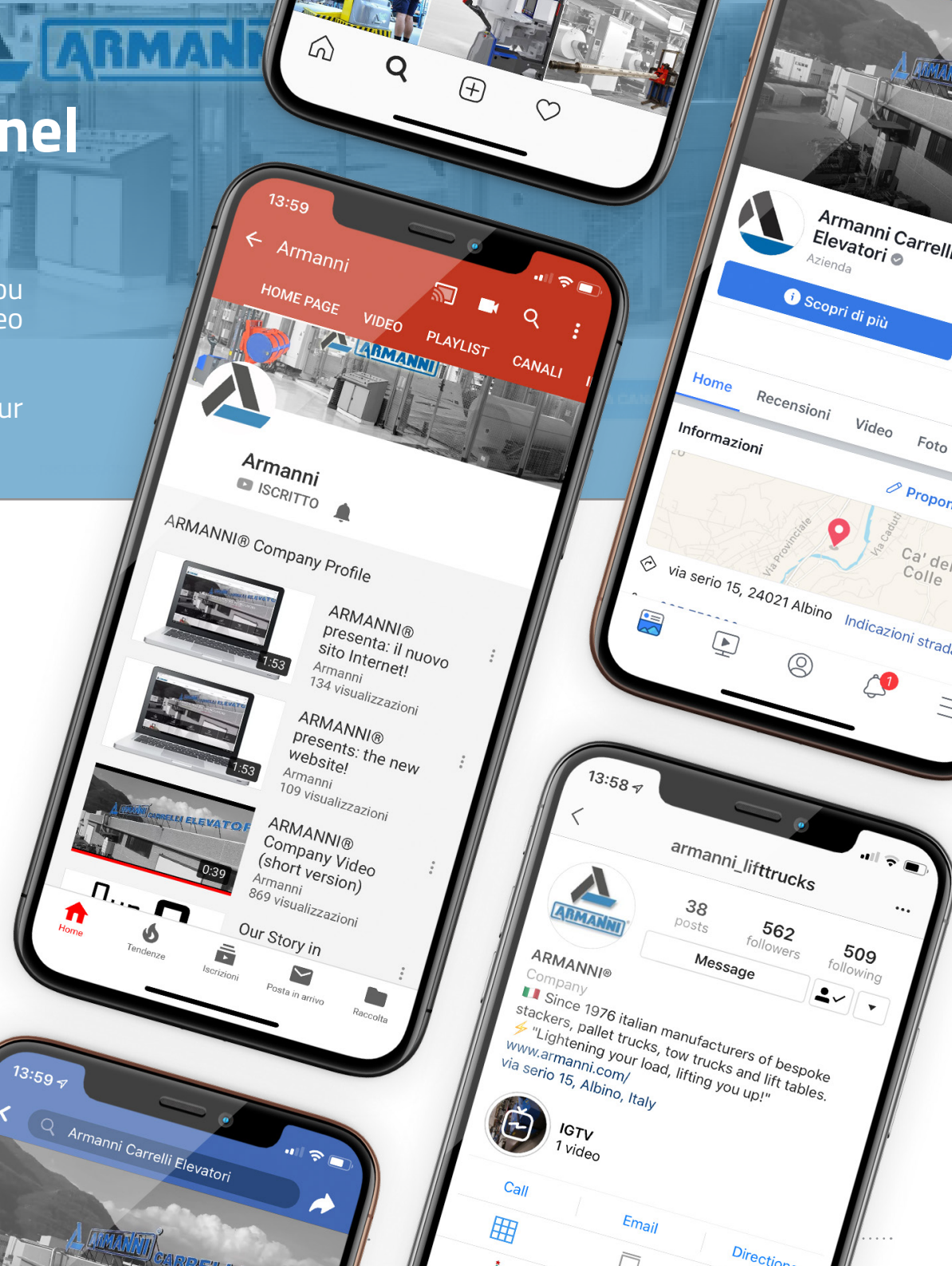





Armanni Carrelli Elevatori Srl  
Via Serio, 15  
24021 Albino (Bg) Italy  
Tel. +39 035 752909  
Mail: [info@armanni.com](mailto:info@armanni.com)

Made in Italy



*[www.armanni.com](http://www.armanni.com)*



*On-line Catalog*

